

Garrett County Department of Public Works – Utilities Division

Water and Sewer Master Plan
Amendment Maps

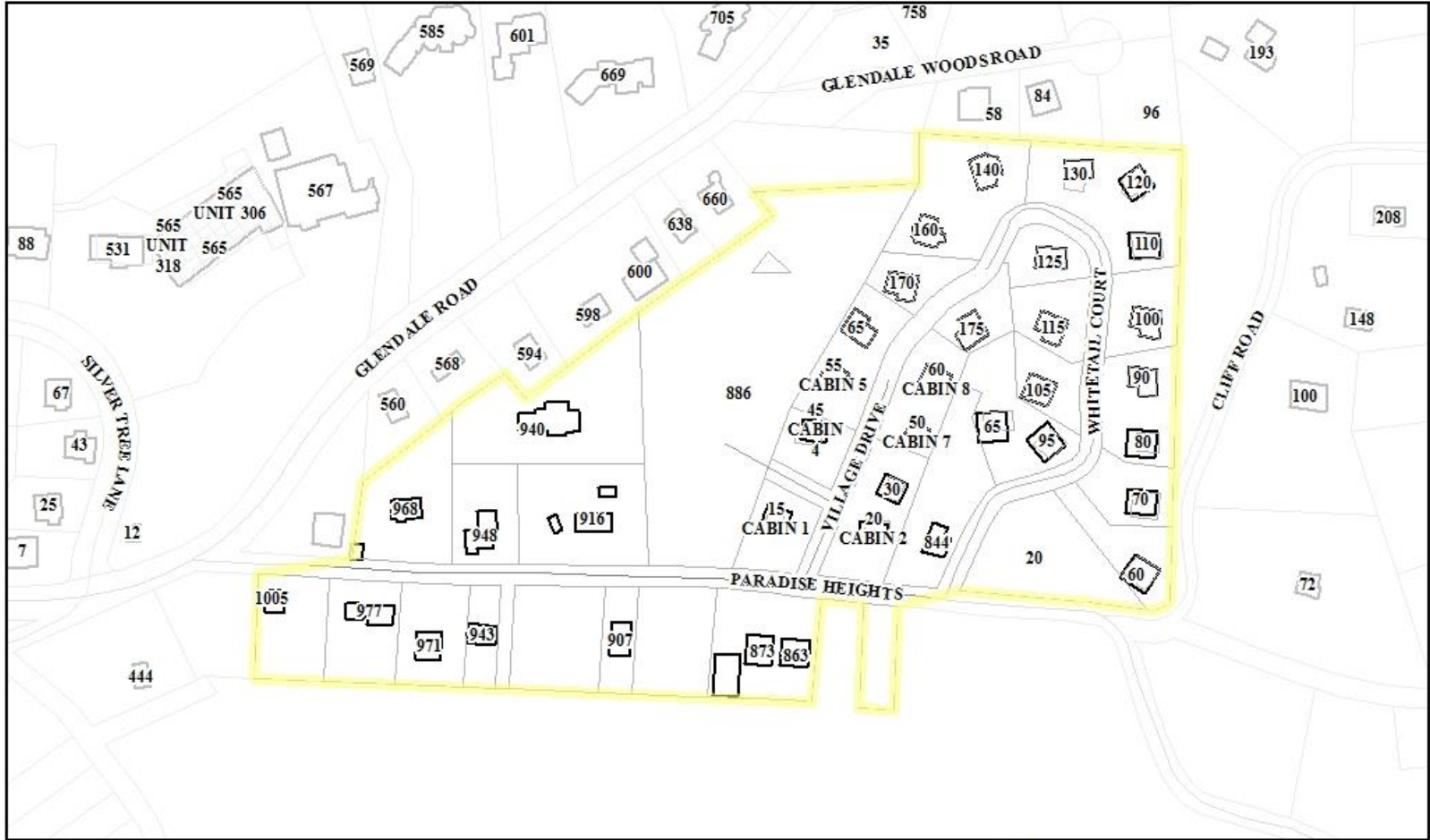

Paradise Heights Road Water Service Area Expansion



0 100 200 400 600 800 Feet

Proposed Expansion
Municipal Boundary
Parcel Boundary

Building
Road Centerline

Pysell Road Sewer Service Area Expansion

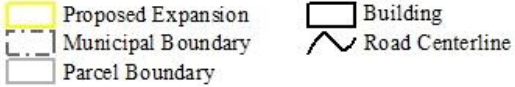
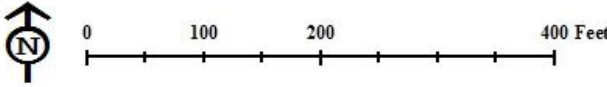
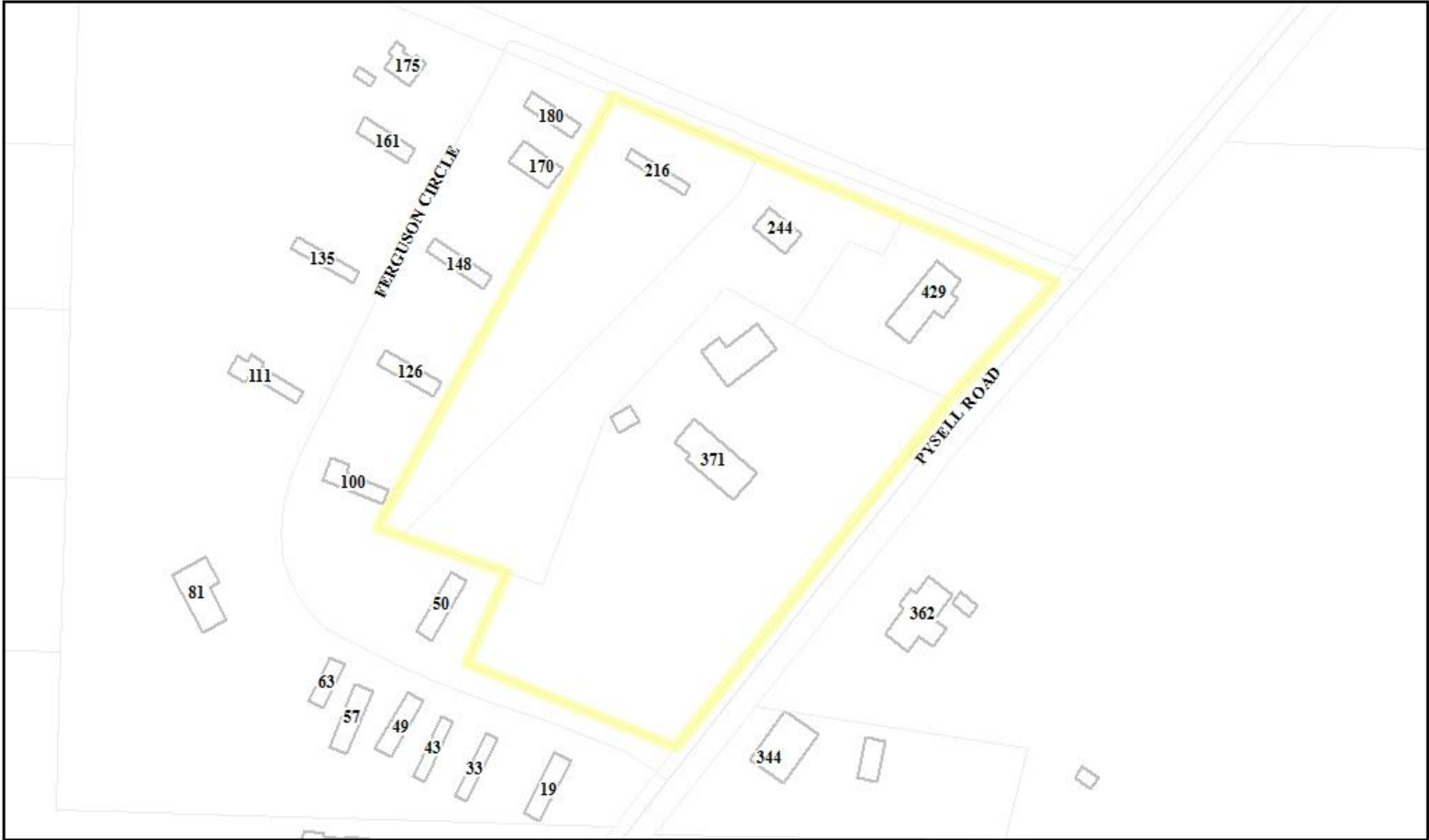

Maple Street Sewer Service Area Expansion

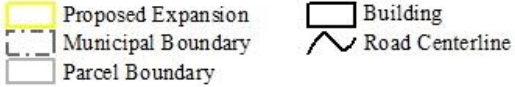
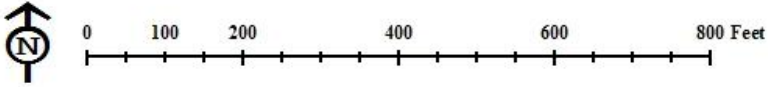
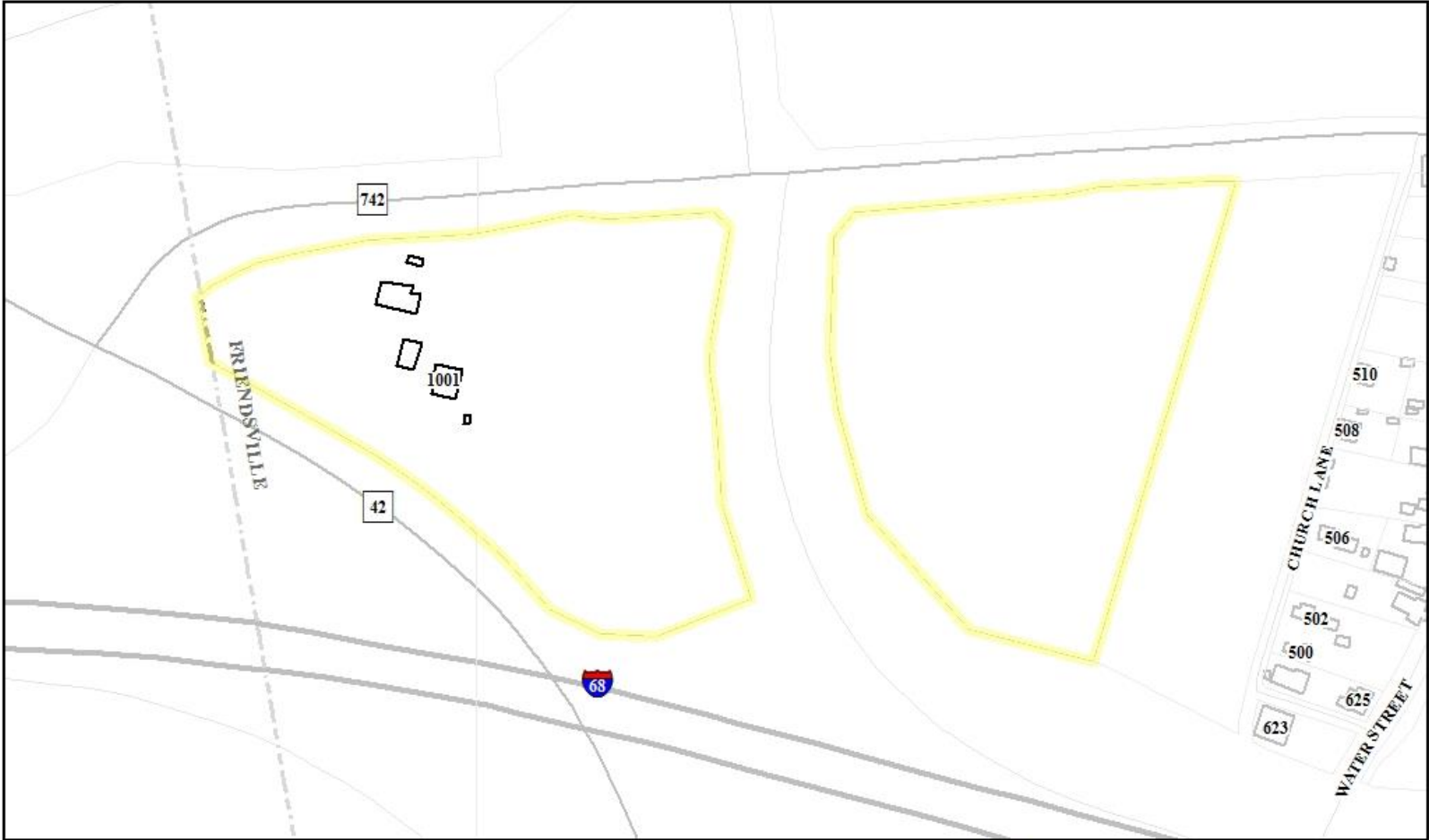

398 Fairview Church Road Water Service Expansion

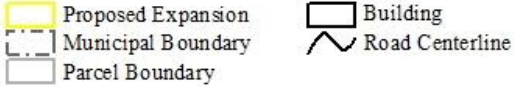
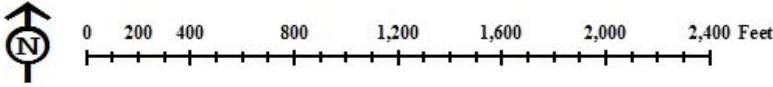

2661 Glendale Road Sewer Service Expansion

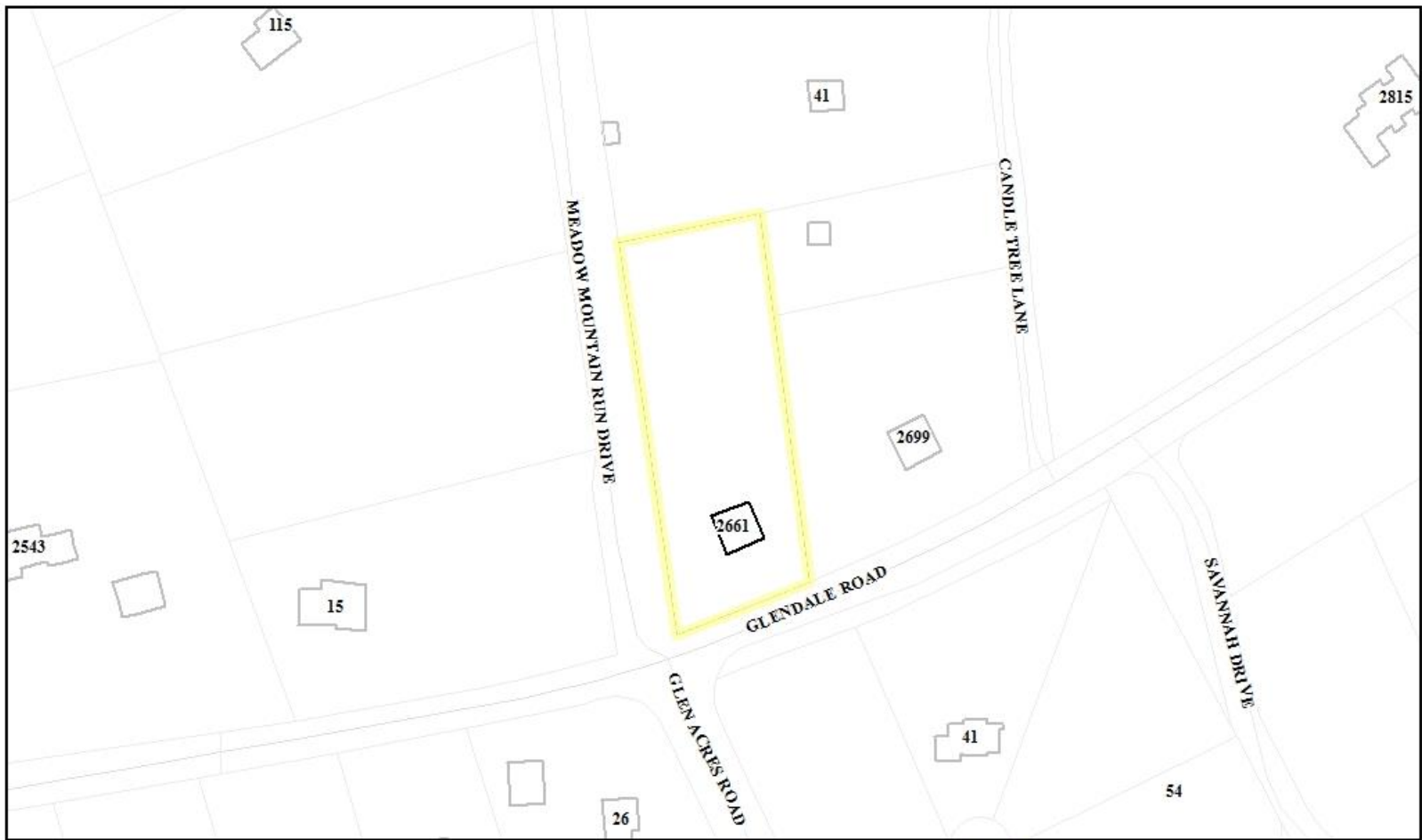

0 100 200 400 Feet

Proposed Expansion
Municipal Boundary
Parcel Boundary

Building
Road Centerline

Mountainside Lots 0118 & 0086 Sewer Service Expansion

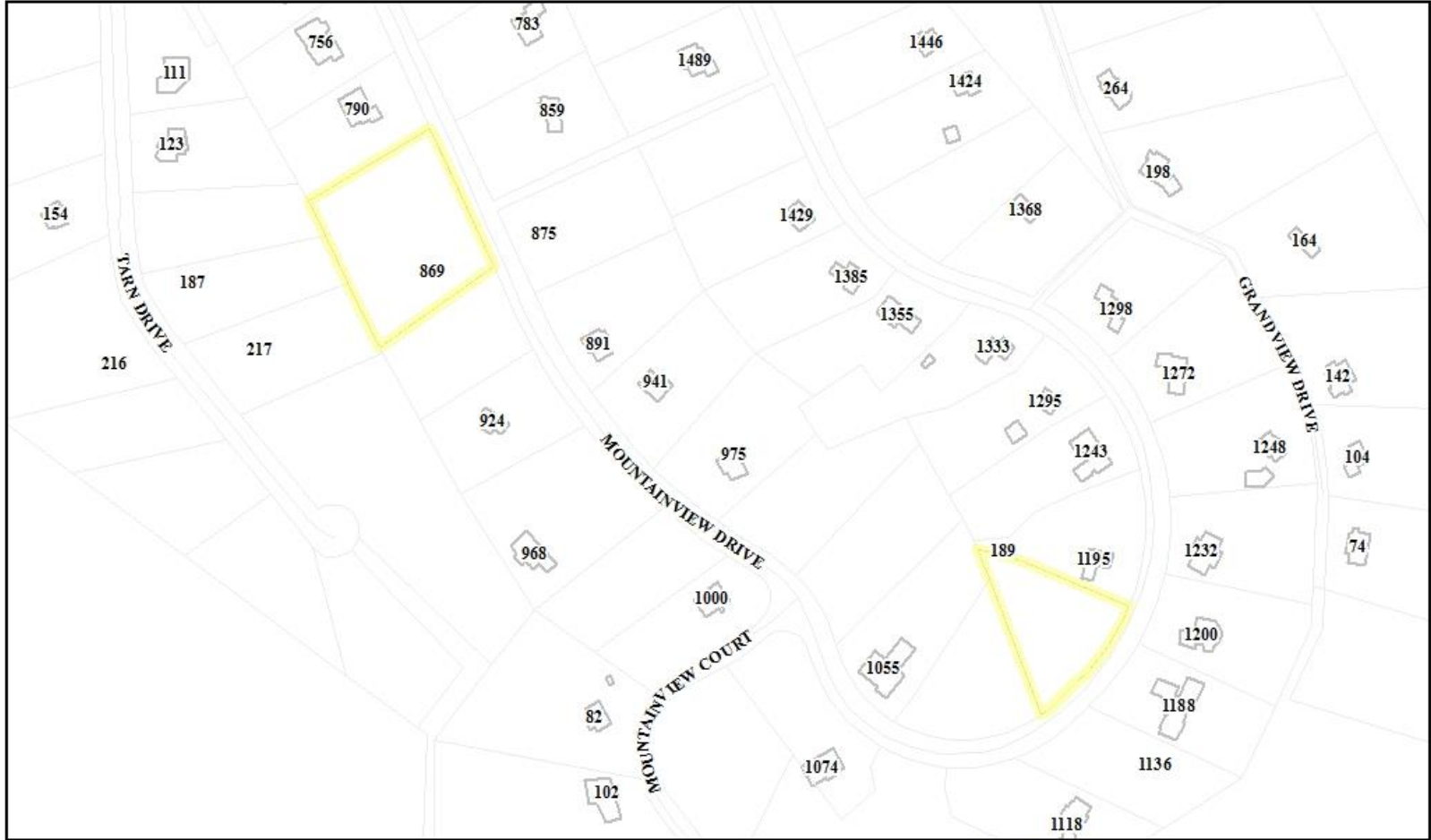

0 100 200 400 600 800 1,000 Feet

Proposed Expansion
Municipal Boundary
Parcel Boundary

Building
Road Centerline

1019 Madison Street Water Service Expansion

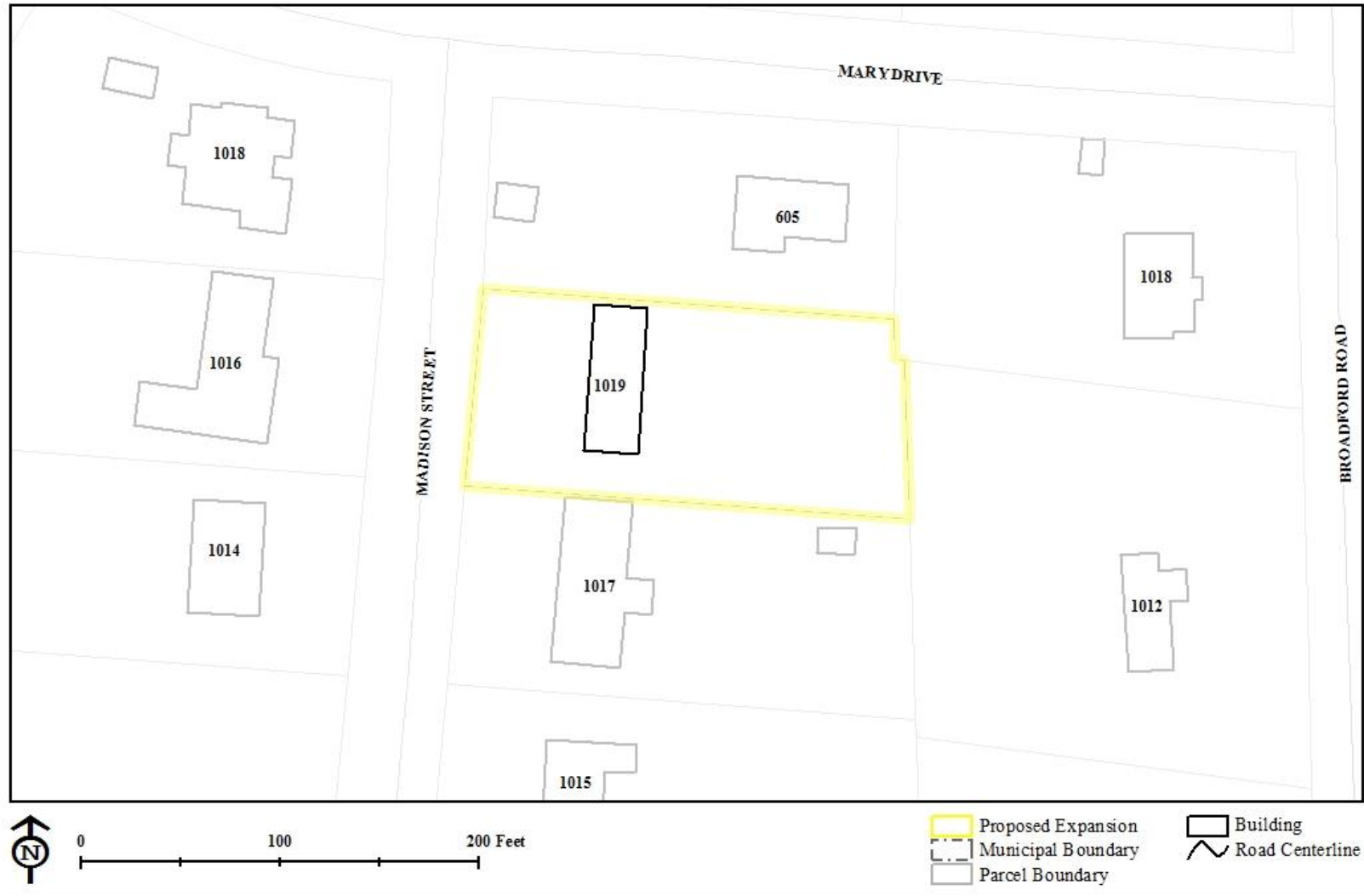

Rosedale Sewer Service Area

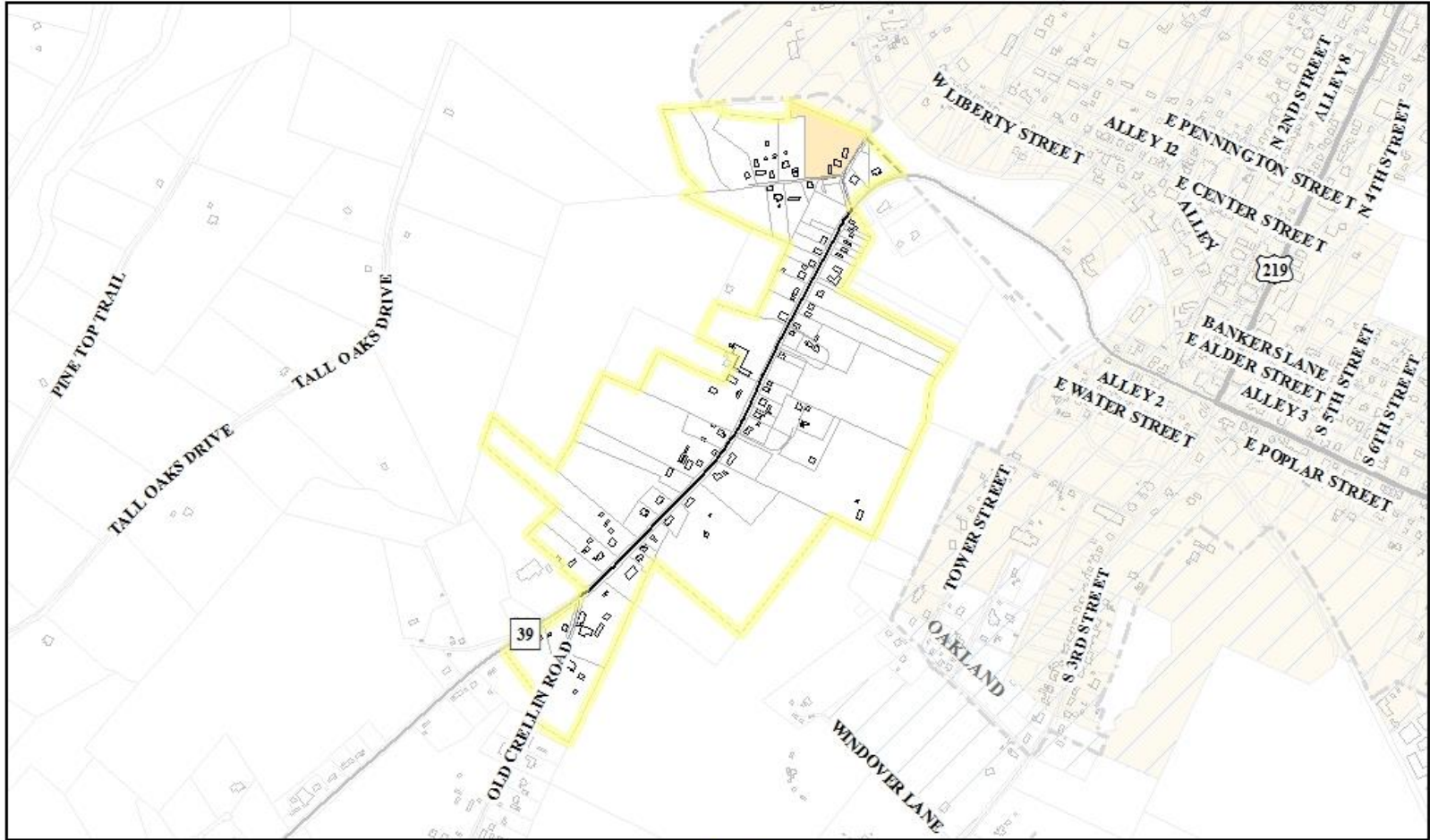

0 300 600 1,200 1,800 2,400 3,000 3,600 Feet

Proposed Expansion
Municipal Boundary
Parcel Boundary

Building
Existing Water Service
Existing Sewer Service

Road Centerline